

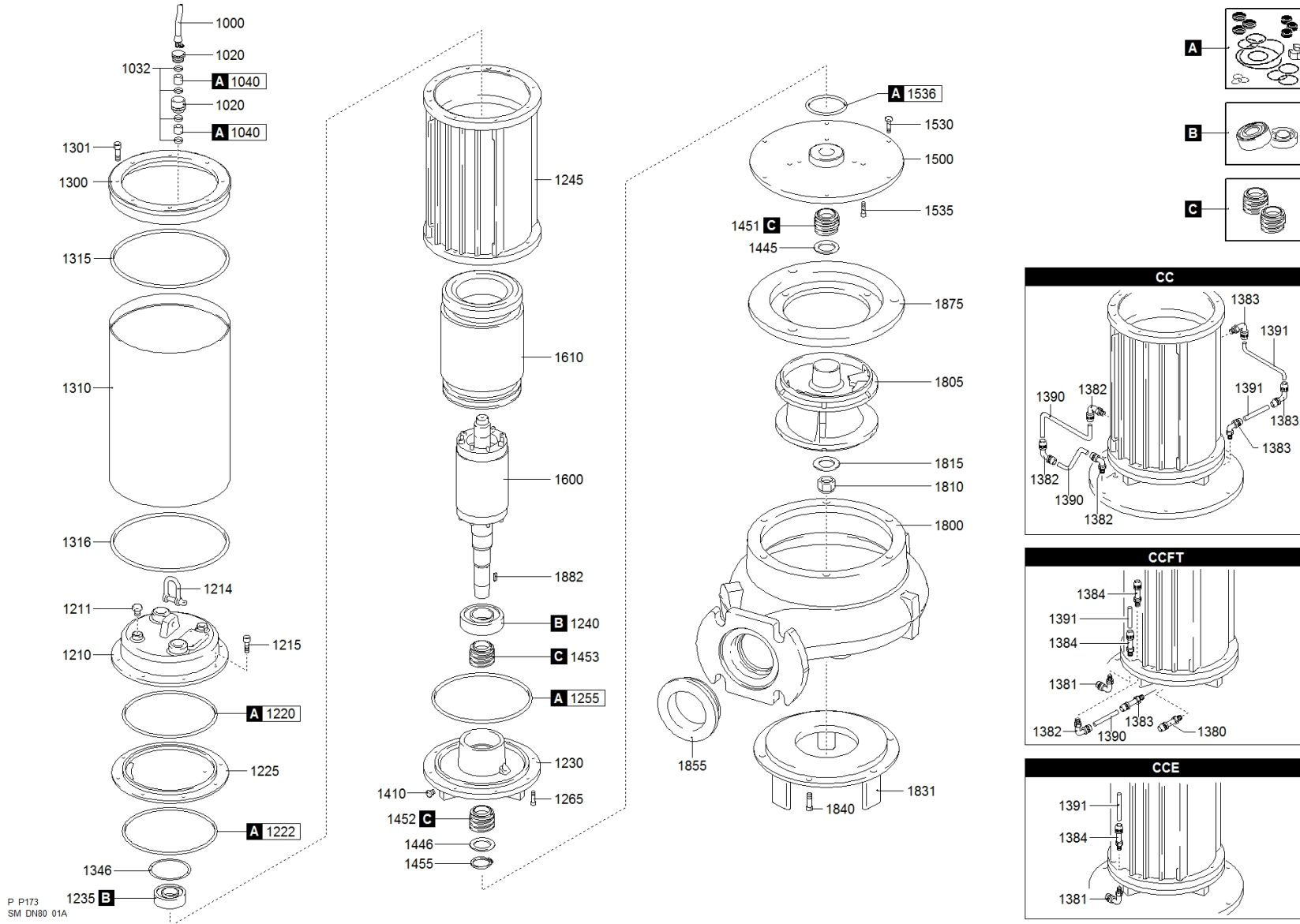

water solutions

0397.003 - SMP 550/2/80 AOGT5 NGTAR81040N00NN



P P173
SM DN80 01A



water solutions



0397.003 - SMP 550/2/80 AOGT5 NGTAR81040N00NN

	Code	Description		Q.ty
A	601018001	GASKETS KIT	600680 or 804843	1
C	602018091	MECHANICAL SEALS KIT		1
B	604020001	BEARINGS KIT		1
1000	25020340251000001	POWER CABLE	802307	1
1020	235440691340	CABLE GLAND [POWER CABLE]		1
1032	270541309100000000	WASHER - CABLE GLAND [POWER CABLE]		4
1040	235672423228	RUBBER GASKET [POWER CABLE]		2
1210	232112208050	COVER		1
1211	270139530104000000	CAP [TIGHTNESS TEST]	802100	1
1214	274421202500000	D-SHACKLE HOOK		1
1215	270830810303200000	SCREW [COVER >> MOTOR CASE]	802091	4
1220	271770171035000000	GASKET [COVER >> UPPER BEARING HOLDER]		1
1222	271770171035000000	GASKET [UPPER BEARING HOLDER >> MOTOR CASE]		1
1225	230612200530	UPPER BEARING HOLDER		1
1230	230512200300	LOWER BEARING HOLDER		1
1235	2729063050400000	UPPER BEARING	710969	1
1240	2729063060200000	LOWER BEARING	710970 or 802082	1
1245	231012200430	MOTOR CASE		1
1255	271770171035000000	GASKET [MOTOR CASE >> LOWER BEARING HOLDER]		1
1265	270830810253200000	SCREW [LOWER BEARING HOLDER >> MOTOR CASE]	802094	4
1315	271770171035000000	UPPER GASKET [EXTERNAL COOLING JACKET]		1
1316	271770171035000000	LOWER GASKET [EXTERNAL COOLING JACKET]		1
1346	27542061000000	WAVE SPRING		1
1410	270149020081422818	CAP [OIL CHAMBER]		1
1445	270531920402000000	WASHER [1st MECHANICAL SEAL]	711049 or 804845	1
1446	270531920402000000	WASHER [2nd MECHANICAL SEAL]	711049 or 804845	1
1451	230000412250000000	1st MECHANICAL SEAL	711400	1
1452	230000412250000000	2nd MECHANICAL SEAL	711400	1
1453	230000000250000000	3th MECHANICAL SEAL	711378	1
1455	270330250100000	SEEGER [1st MECHANICAL SEAL >> 2nd MECHANICAL SEAL]	802101	1
1500	236212002500280	PUMP PLATE	600675	1
1530	270830810353200000	SCREW [PUMP PLATE >> PUMP BODY]	807364	6
1535	270830810203200000	SCREW [PUMP PLATE >> LOWER BEARING HOLDER]	802093 or 802095	6
1536	271770082026000000	GASKET [PUMP PLATE >> LOWER BEARING HOLDER]	801117	1
1600	230230512815590	SHAFT WITH ROTOR		1
1610	230801283001000000	WOUND STATOR		1
1650	2790300422785	DATAPLATE		1
1655	273130000000	RIVET [DATAPLATE]	802085	2

1800	21251020030520250	PUMP BODY		1
1805	21411301400817660	IMPELLER		1
1810	27073180932123771	LOCKING IMPELLER	711113	1
1815	270531514302000000	LOCKING WASHER [IMPELLER]	711048	1
1831	2145120017690	SUCTION FLANGE WITH FOOT		1
1840	270830810203200000	SCREW [SUCTION FLANGE >> PUMP BODY]	802093 or 802095	6
1855	2750730403100	DISCHARGE GASKET	711032	1
1875	236412002517630	HYDRAULIC UNION RING		1
1882	270430606025100000	KEY [IMPELLER]	711071	1